

Strips and Strings

Cutting and assembly diagrams

Cutting instructions for each of the blocks in *Strips and Strings* along with assembly diagrams are provided here. Note that the cutting is for one block.

Read more about using leftover scraps in quilt blocks in *Strips and Strings* in *Quiltmaker* Sept/Oct '10 (No. 135). If you cannot find this issue at your local quilt shop, order back issues at shopquiltmaker.com.

Double Pinwheel: Alternately sew black dot and gray print strips together, angling each successive strip as shown. After adding each strip, trim the seam allowances to $\frac{1}{4}$ ". Sew enough strips together to make 2 squares approximately 8" x 8". Trim the squares to $6\frac{7}{8}$ " x $6\frac{7}{8}$ ". Cut each square in half diagonally to yield 2 triangles (A). (There will be 4 A's total.) Join the patches as shown to make a section. Make 4 sections. Sew the sections together to complete the block.

Sailboat: Refer to the technique "Triangle-Squares" to make 4 unit 1's using the blue print A's and the yellow dot A's. Refer to the "Stitch & Flip" technique to sew a blue C to each end of the red print B to make the unit 2. Sew the strips together, angling each successive strip as shown, to make a rectangle approximately 3" x 9". After adding each strip, trim the seam allowances to $\frac{1}{4}$ ". Trim to a rectangle $2\frac{1}{2}$ " x $8\frac{1}{2}$ " (B). Sew the units and patches together as shown.

Cake Stand: Refer to the technique "Triangle-Squares" and use the cream A's and green A's to make 6 units. Beginning and ending with a brown strip, sew the strips together, alternating the brown and cream. Make a plastic template of the B patch (draw a $6\frac{7}{8}$ " x $6\frac{7}{8}$ " square and cut it in half diagonally). Use this template to cut a B from the pieced strips as shown. Sew the units and patches together to complete the block.

technique

Triangle-Squares.

With right sides together and the lighter fabric on top, pair one square of each color that makes the unit. On the lighter patch, draw a diagonal line from corner to corner.

Stitch $\frac{1}{4}$ " out from both sides of the line.

Cut apart on the marked line.

With the darker fabric up, open out the top patch and press the block.

A pair of squares will yield 2 units.

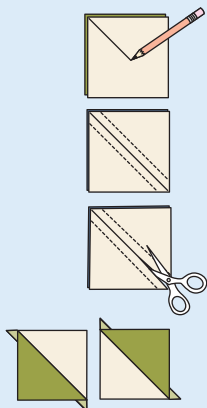

Double Pinwheel 12" x 12"

Fabric: Boo to You by My Mind's Eye for Riley Blake Designs.

For each block:

Black Dot and Gray Print
from each:

2"-wide strips, approximately 8" long

Multicolor Stripe

1 square $7\frac{1}{4}$ " x $7\frac{1}{4}$ " cut diagonally twice to yield 4 triangles (B) ☒

Orange Dot

1 square $7\frac{1}{4}$ " x $7\frac{1}{4}$ " cut diagonally twice to yield 4 triangles (B) ☒



A
Make 4

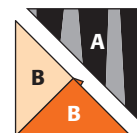

Section Assembly



Block Assembly



Sailboat 8" x 8"

For each block:

Yellow Dot

2 squares (A) 2 7/8" x 2 7/8"

Light Blue Print

2 squares (A) 2 7/8" x 2 7/8"

2 squares (C) 2 1/2" x 2 1/2"

2 rectangles (D) 2 1/2" x 4 1/2"

Red Print

1 rectangle (B) 2 1/2" x 8 1/2"

2 Green Prints and 2 Aqua Prints

From each:

1"-wide strip, approximately 9" long

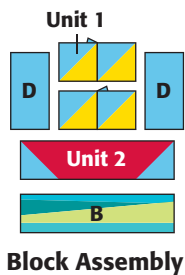
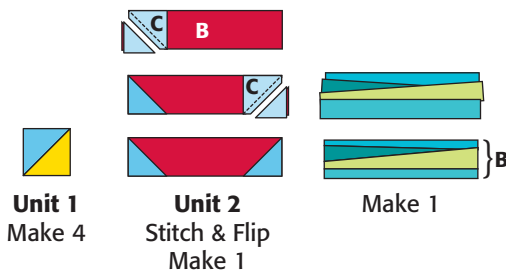

Cake Stand 10" x 10"

Fabric: Halo by Gudrun Erla for Red Rooster Fabrics.

For each block:

Cream Tone-on-Tone

3 squares (A) 2 7/8" x 2 7/8"

1 square (C) 2 1/2" x 2 1/2"

2 rectangles (D) 2 1/2" x 6 1/2"

1 square 4 7/8" x 4 7/8" cut diagonally to yield 2 triangles (F) (there will be 1 extra triangle)

Green Tone-on-Tone

3 squares (A) 2 7/8" x 2 7/8"

Cream Floral

1 square 6 7/8" x 6 7/8" cut diagonally to yield 2 triangles (B) (there will be 1 extra triangle)

Brown Print

1 square 2 7/8" x 2 7/8" cut diagonally to yield 2 triangles (E)

7 strips 1 1/2" x 6"

Cream Print

6 strips 1" x 6"

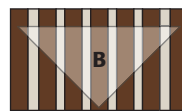

Unit
Make 6

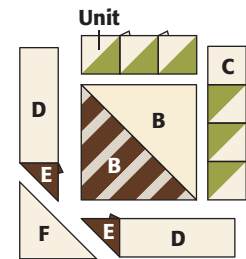

technique

Stitch & Flip. Align a C patch in the corner of patch B, right sides together, as shown.

Mark a diagonal line on the C from corner to corner and sew on the marked line. Trim the seam allowance to 1/4", flip the C patch open and press.