

Go Big!

Cutting and assembly diagrams

Cutting instructions for each of the blocks in *Go Big!* along with assembly diagrams are provided here. Note that the cutting is for one block.

Read more about using large-scale prints in quilt blocks in *Go Big!* in *Quiltmaker* May/June '10 (No. 133). If you cannot find this issue at your local quilt shop, order back issues at shopquiltmaker.com.

Frame: refer to the technique “Triangle-Squares” to make the unit 1’s using the A’s and the colors shown. Refer to the technique “Fast Flying Geese” to make the unit 2’s using the cream print B’s and pink dot A’s.

Attic Windows: refer to the technique “Triangle-Squares” to make the unit 1’s using the A’s and the colors shown. There will be 1 extra unit 1.

Windy City: refer to the “Stitch & Flip” technique to make the unit 1’s and unit 2’s.



Frame 12" x 12"

Fabric: *Housework Whenever* by *In the Beginning Fabrics*.

For each block:

Cream Print

2 squares (A) 27/8" x 27/8"

2 squares (B) 5 1/4" x 5 1/4"

Purple Print

2 squares (A) 27/8" x 27/8"

Pink Dot

8 squares (A) 27/8" x 27/8"

Novelty Print

1 square (C) 8 1/2" x 8 1/2"



Attic Windows 21 3/4" x 21 3/4"

Fabric: *On the Rio Grande* by *Terrie Mangat* for *FreeSpirit*.

For each block:

Orange Solid

5 squares (A) 2 3/8" x 2 3/8"

9 rectangles (B) 2" x 6 1/4"

Rust Solid

5 squares (A) 2 3/8" x 2 3/8"

9 rectangles (B) 2" x 6 1/4"

Novelty Panel

9 squares (C) 6 1/4" x 6 1/4"

technique

Triangle-Squares.

With right sides together and the lighter fabric on top, pair one square of each color that makes the unit. On the lighter patch, draw a diagonal line from corner to corner.

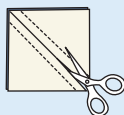

Stitch 1/4" out from both sides of the line.

Cut apart on the marked line.

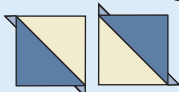

With the darker fabric up, open out the top patch and press the block.

A pair of squares will yield 2 units.

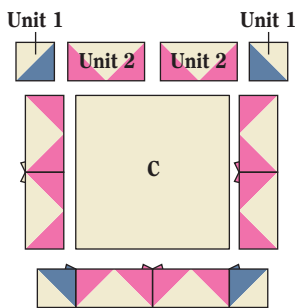
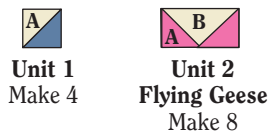

Block Piecing

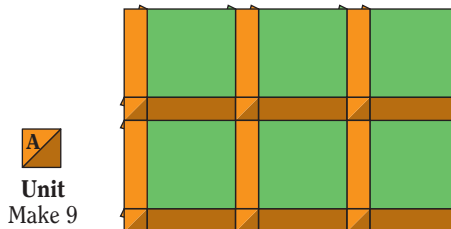
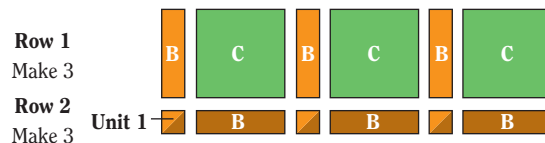

Block Piecing



Windy City 8" x 8"

Fabric: Aloha Prints by Laundry Basket Quilts for Moda Fabrics.

For each block:

Green Print

4 rectangles (A) 2½" x 4½"

Purple Print

4 squares (B) 2½" x 2½"

Large-scale Print

4 rectangles (A) 2½" x 4½"

Cream Print

4 squares (B) 2½" x 2½"

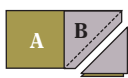

Unit 1
Stitch & Flip
Make 4



Unit 2
Stitch & Flip
Make 4



Block Piecing

technique

Fast Flying Geese. Align 2 pink A's on opposite corners of a cream B, right sides together. Draw a diagonal line as shown and then stitch ¼" out from both sides of the line. Cut apart on the marked line.

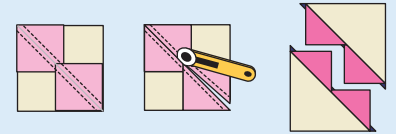

With the pink fabric on top, open out the A's and press the unit.

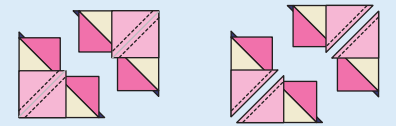

On the remaining corner of each of these units, align pink A's. Draw a line from corner to corner and sew ¼" out on both sides of the line. Cut on the marked lines, open the A's and press.

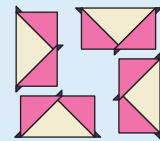

Each set of 1 B and 4 A's makes 4 Flying Geese.

technique

Stitch & Flip. Align a B patch on the right edge of patch A, right sides together, as shown. Mark a diagonal line on the B from corner to corner and sew on the marked line. Trim the seam allowance to ¼", flip the B patch open and press.